

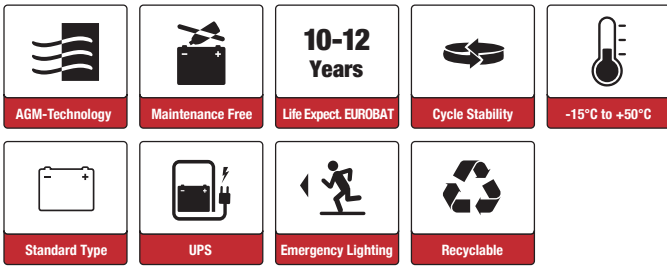

SBL26-12L ES (12V26Ah)

Item Nr.: SSB2037974



Applications

- Uninterruptable Power Supply (UPS)
- Electric Power System (EPS)
- Emergency backup power supply
- Emergency light
- Railway signal
- Alarm and security system
- Communication power supply
- DC power supply



Certificates

Conform to
IEC60896-21&22

Specifications

Nominal Voltage	12V	Operating Temp. Range	Discharge: -15~50°C
Nominal Capacity	26Ah (C ₂₀ , 10.5V)		Charge: -15~45°C
Approx. Weight	7.4kg		Storage: 5~30°C
Terminal	F-M5	Float Charge	2.277V/cell@20°C, 2.260V/cell @25°C
Container Material	ABS UL94 HB		Charging Current: 0.1-0.3C
Rated Capacity (20°C)	26Ah/1.3A, 20hr, 10.5V	Boost Charge	Temperature Coefficient: 3mV/cell/°C
	24.60Ah/2.46A, 10hr, 10.5V		2.367V/cell@20°C, 2.350V/cell@25°C
	24.24Ah/3.03A, 8hr, 10.5V		Charging Current: 0.1-0.3C
	22.65Ah/4.53A, 5hr, 10.5V	Self Discharge	Temperature Coefficient: 3mV/cell/°C
	20.1Ah/6.70A, 3hr, 10.5V		SSB batteries may be stored for up to 6 months
	15.09Ah/15.09A, 1hr, 9.6V		at 20°C (self-discharge per month ≤3%) and then
Max. Discharge Current	260A (5s)		a freshening charge is required. For higher tempera-
Internal Resistance / Impedance (1kHz)	Approx. 16mΩ	Life Expectancy	tures the time interval will be shorter.
Nominal Oper. Temp. R.	20±2°C		10-12 years according to EUROBAT (Long Life)

Dimensions

■ F-M5 Terminal

Unit: mm | Dimensions: 166±1.5 Length X 176±1.5 Width X 125±1.5 Height (125±1.5 Height incl. Terminal)

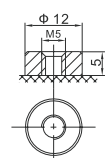
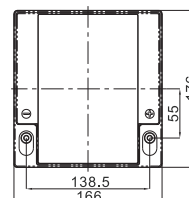
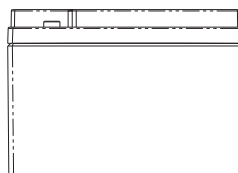
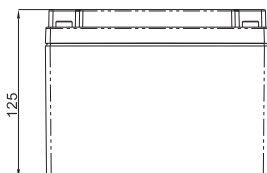

Constant Current Discharge (Amperes) at 20°C

F.V/Time	5min	10min	15min	30min	1h	2h	3h	4h	5h	8h	10h	20h
1.60V	93.72	66.23	47.88	27.50	15.09	9.753	7.332	5.920	4.905	3.157	2.564	1.354
1.65V	87.15	62.59	45.77	26.40	14.57	9.442	7.106	5.759	4.777	3.121	2.532	1.332
1.70V	78.63	57.62	42.87	25.23	14.10	9.131	6.913	5.603	4.653	3.073	2.494	1.316
1.75V	70.45	52.74	39.90	24.12	13.58	8.812	6.706	5.459	4.536	3.031	2.461	1.300
1.80V	61.86	47.74	36.84	23.05	13.06	8.497	6.499	5.302	4.419	2.979	2.430	1.287
1.85V	49.10	39.02	30.57	19.85	11.72	7.785	6.008	4.928	4.121	2.797	2.287	1.222

Constant Power Discharge (Watts/cell) at 20°C

F.V/Time	5min	10min	15min	30min	1h	2h	3h	4h	5h	8h	10h	20h
1.60V	155.4	112.6	83.70	49.95	28.36	18.49	14.00	11.36	9.454	6.165	5.039	2.665
1.65V	146.1	108.4	81.21	48.45	27.54	17.98	13.63	11.10	9.243	6.108	4.985	2.627
1.70V	134.9	101.7	77.20	46.78	26.81	17.49	13.32	10.84	9.034	6.028	4.916	2.598
1.75V	123.5	94.73	72.88	45.17	25.99	16.95	12.97	10.60	8.837	5.956	4.858	2.570
1.80V	110.8	87.25	68.25	43.61	25.14	16.43	12.62	10.33	8.640	5.868	4.802	2.547
1.85V	89.76	72.57	57.44	37.93	22.69	15.13	11.72	9.640	8.084	5.522	4.527	2.422

Discharge Characteristics

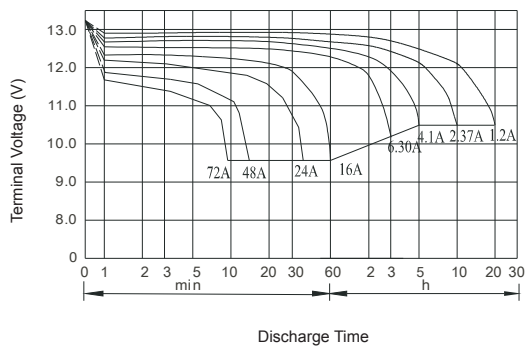

Float Charging Characteristics

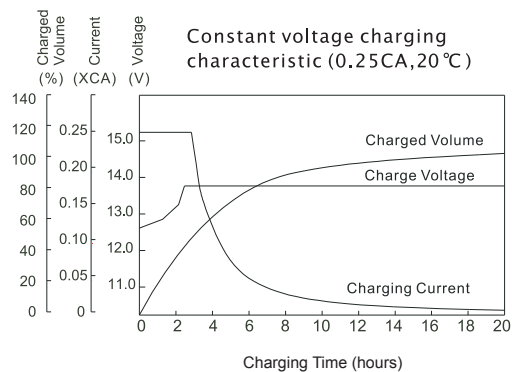

Temperature Effects in Relation to Battery Capacity

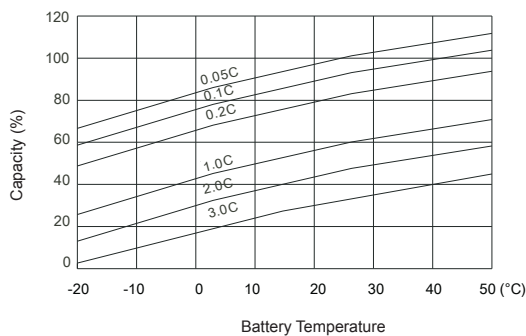

Effect of Temperature on Long Term Float Life

